

## Z-WAVE LIGHT KIT INSTALLATION FOR I-DRIVE TORQUEMASTER® PRO

### Installation Instructions

P.O. Box 67 Mt. Hope, OH 44660

© 2009 Wayne-Dalton Corp. Part No. 340103 New 6/04/2009

This insert is to be used in conjunction with the Main Installation Instructions and Owner's Manual.  
This insert is for Z-Wave i-drive TorqueMaster® Pro Operator Only!

www.wayne-dalton.com

Tools Needed:  
Step Ladder  
Phillips Screw Driver

Select a grounding type receptacle on either the ceiling or wall. If one is not available, have one installed by a qualified electrician.

**IMPORTANT! DOOR MUST CLEAR LIGHT FIXTURE WHEN THE DOOR IS IN THE OPEN POSITION.**

Identify a mounting location for the light fixture that's in close proximity to the receptacle, and within reaching distance of the power cord. Fasten the mounting bracket to a stud, in the desired location using (2) #10 x 1-1/2" deep thread screws. Align the two metal tabs on the mounting bracket. Hold the light fixture flush against the mounting bracket using (1) #8 x 0.375" screw as shown. Place the hole plug into the screw hole in the light fixture.

**NOTE:** For temperature protection, the hole plug must be in place prior to using the light fixture.

### **WARNING**

TO AVOID ELECTRICAL SHOCK/FIRE, DO NOT CHANGE THE POWER CORD PLUG IN ANY WAY.

**IMPORTANT! TURN RECEPTACLE POWER OFF FROM THE FUSE/BREAKER BOX.**

**IMPORTANT! THE POWER CORD HAS A GROUNDING TYPE PLUG WITH A THIRD (GROUNDING) PIN. THIS PLUG WILL ONLY FIT INTO A GROUNDING TYPE OUTLET. IF THE PLUG DOES NOT FIT INTO YOUR OUTLET, CONTACT A QUALIFIED ELECTRICIAN TO INSTALL THE PROPER GROUNDING TYPE OUTLET. DO NOT ALTER THE PLUG IN ANY WAY.**

Plug the female end of the power cord into the inlet connect of the light fixture. Now, plug the other end of the power cord into the nearest grounding type receptacle. As soon as power is applied to the light fixture it should blink one time. Use cable clips and #6 x 7/8" wood screws to secure the power cord.

Screw a 15W Type-A bulb or 19W Compact Fluorescent (maximum) light bulb into light socket and snap diffuser into light fixture.

**NOTE:** When installing diffuser, make sure all three snap tabs are aligned and fully snapped into the three mating slots of the light fixture.

Turn receptacle power back on at fuse/breaker box. The light should blink one time when the power is turned back on.

**IMPORTANT! FOR REPLACEMENT BULBS USE ONLY 19W MAX COMPACT FLUORESCENT BULBS OR USE ONLY 15W MAX TYPE-A BULBS FOR THE LIGHT.**

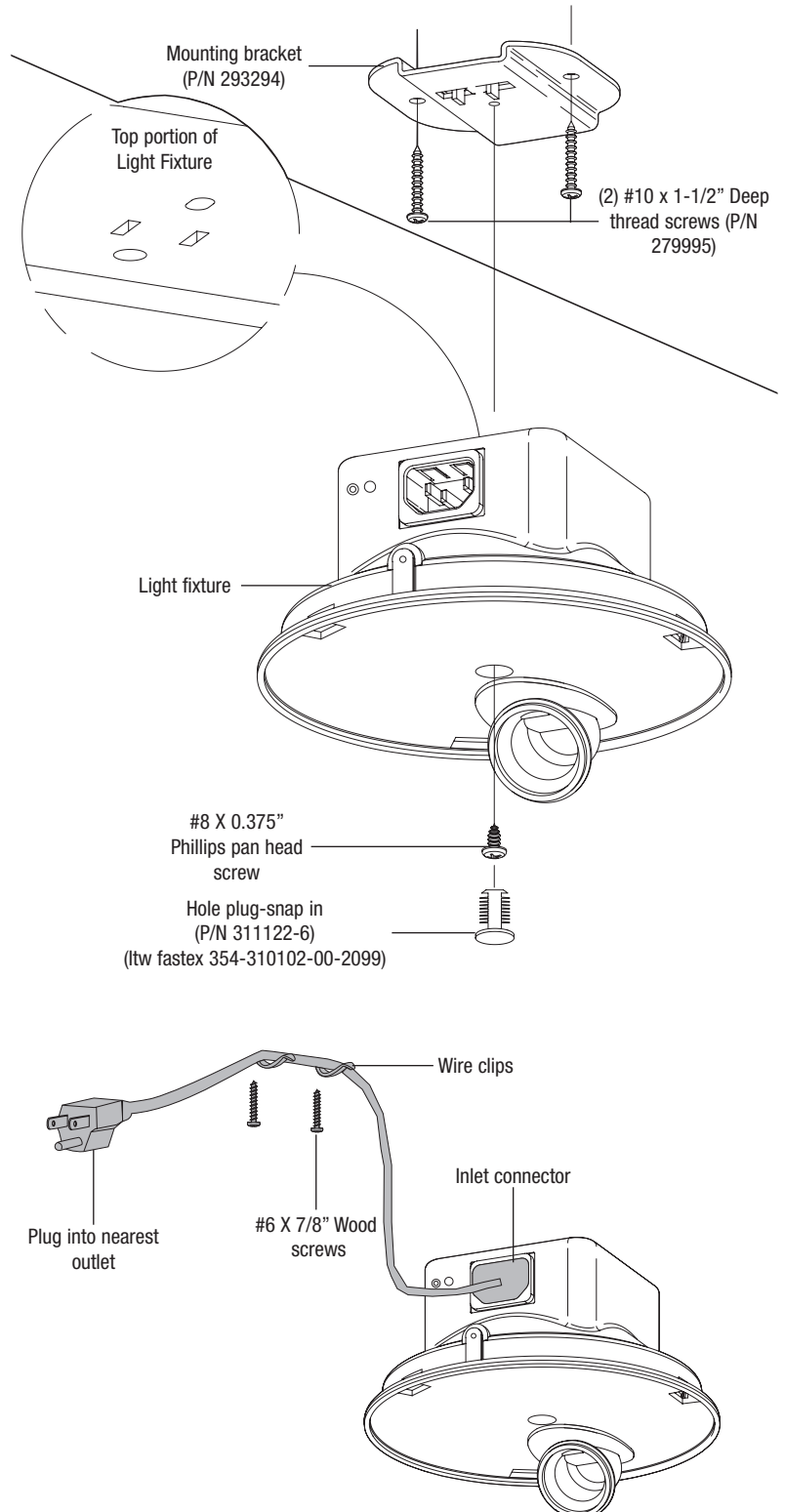

## Programming the Z-Wave Light Kit

### PROGRAMMING THE Z-WAVE LIGHT KIT TO THE I-DRIVE TORQUEMASTER PRO-Z

If your Z-Wave Light Kit is included with the opener, it should already be programmed to the opener. Otherwise, follow the instructions below.

**IMPORTANT:** ERASE ANY EXISTING PROGRAMMING ON Z-WAVE LIGHT KIT.

1. Press and hold the DELETE button on the unplugged Wireless Gateway until the 3 LEDs turn on, then let go of the button.
2. Press the red button on the Z-Wave Light Kit and observe the LEDs on the Wireless Gateway flash. All network programming, if any, has now been deleted from the Z-Wave Light Kit. Press the red button again to turn off the light. If the button is held in, the Z-Wave Light Kit may flash its light on and off repeatedly. This is okay.

### PROGRAM Z-WAVE LIGHT KIT TO PRIMARY CONTROLLER

1. Insure the Z-Wave Light Kit light is off.
2. Press the Scene 1 button on the Wireless Gateway and observe that the LED lights up. Continue holding the button down until the LED turns off and the turns back on again.
3. While the Scene 1 button is still being pressed, press the red button on the Z-Wave Light Kit, while observing the LED for Scene 1. If the LED flashes, the Z-Wave Light Kit has been successfully programmed to Scene 1 of the Wireless Gateway.
4. Release the button on the Wireless Gateway.
5. Note: If the programming was unsuccessful, try moving the Wireless Gateway closer to the Z-Wave Light Kit or change orientation.

### COPY PRIMARY CONTROLLER PROGRAM TO THE Z-WAVE OPERATOR

1. Press and hold the Learn button on the I-Drive TorqueMaster® Pro-Z until all 4 LEDs are blinking. Release the button.
2. With the Wireless Gateway in close proximity to the I-Drive TorqueMaster® Pro, press and hold the copy button on the Wireless Gateway until all 3 LEDs are flashing.
3. Observe the 4 LEDs on the I-Drive TorqueMaster® Pro-Z. If programming is successful, the LEDs will begin blinking at a different rate, and then turn off. If not, then you may have to move the Wireless Gateway closer or change the orientation.
4. The Z-Wave Light Kit will now come on when the operator is engaged. The light will automatically shut off after approximately 5 minutes. Additionally, by default, Scene 3 will turn off Scene 1. Therefore, the light can be turned off by pressing Scene 3 on the Wireless Gateway.

